

# M6™ Controller

## Power cycle reliability improvement

---

### Symptom

In some M6™ controllers, the mainboard may not start-up while all other parts of the controller are powered-up normally.

### Solution

Jumper J\_ATXCTL1 must be set from position 1-2 to position 2-3.

### Anti-Static Precautions

***Important! Static electricity can destroy electronic components. Follow these ESD precautions to prevent damage to the product and injury to the user.***

Carry out the service at an anti-static workstation.



Wear a grounded anti-static wristband.

Touch a grounded conductor every few minutes to discharge any static buildup.

Hold components by their edges only. Do not touch the surfaces or any of the contacts of the PCBs.



## Setting jumper J\_ATXCTL1

	<ol style="list-style-type: none"><li>1. Switch the controller OFF and disconnect the power cable from the controller.</li></ol>
	<ol style="list-style-type: none"><li>2. Open the right back cover of the controller (seen from the back of the controller): unscrew 5 screws (Use a torx T-10)</li></ol>
	<ol style="list-style-type: none"><li>3. Slide the cover plate from the controller</li></ol>

**Martin**<sup>®</sup>

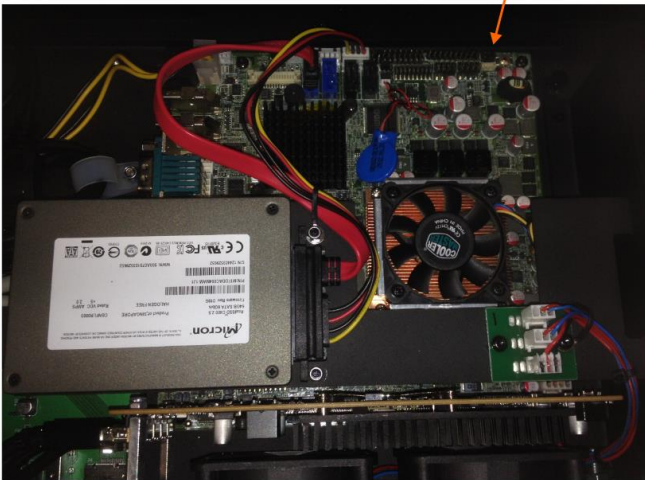

4. Locate Jumper “J\_ATXCTL1” on the mainboard (see arrow).

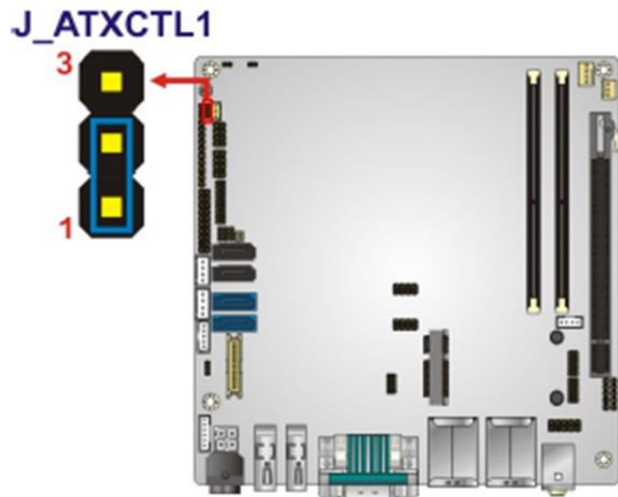

**Martin**

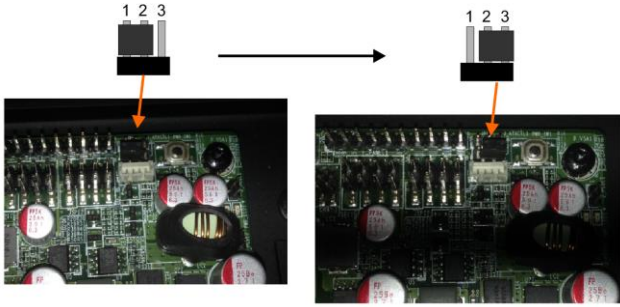
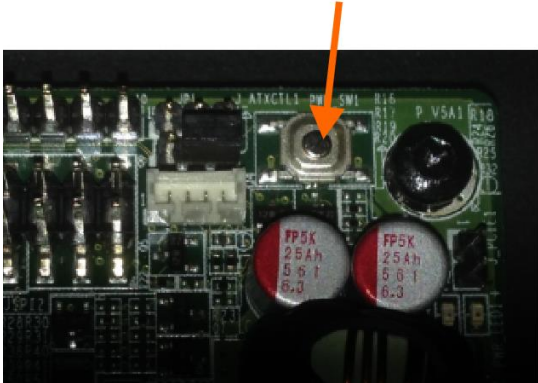
	<p>5. Jumper is in position 1-2. Set jumper to position 2-3.</p>
	<p>6. Connect power to the controller and switch ON.</p>
	<p>7. If the mainboard doesn't power up, press the power-on switch on the mainboard (to the right of the jumper).</p>
	<p>8. Wait until the menu appears on the screen, and power-off (mains switch on the front).</p> <p>9. Power-on again (mains switch on the front). The mainboard should now start automatically.</p> <p>10. Power-off again and close the controller.</p>

**Martin**<sup>®</sup>